

7 Ishikawa Prefectural Youth Training Center

212-1 Tokiwa-machi, Kanazawa 920-0834
 TEL: 076-252-0666 FAX: 076-252-7177



Restaurant



■ Number of seats
300 seats (Hall)



■ Traffic access
 25-min bus ride from JR Kanazawa Station
 (Get off at Suzumidai-1chome and walk for 7 min.)
 10 min by taxi from JR Kanazawa Station



■ Hours
 9:00am~10:00pm
 Closed: Year-end and New Year's holidays
 (Dec. 29~Jan. 3)

■ Date to start accepting reservation
 Six months before the date of use



■ Accommodation

| | |
|------------------------|-----------------------------|
| • Quadruple room: | 12 |
| • Triple room: | 6 |
| • Twin room: | 2 |
| • Japanese-style room: | 4 |
| • Other room: | 1 |
| Total: | 25 rooms (99 people) |



■ Restaurants/Cafés

- Restaurant: 100 seats
- Café: 45 seats



■ Parking Capacity
120 vehicles (free)



■ Remarks
 Permanent simultaneous interpretation booth (Hall)
 Simultaneous interpretation equipment (movable)
 Large bathroom

■ Convention site

| Site name | Floor | Area (㎡) | Width×Depth (m) (m) | Ceiling height (m) | Capacity (persons) | | | | | Remarks |
|--------------------------|-------|----------|---------------------|--------------------|--------------------|--------|---------|--------|--------|-----------------------------------------------------------------|
| | | | | | Fixed seats | School | Theater | Seated | Buffet | |
| Hall | 2 | 272 | 17.0×16.0 | 3.5 | — | 180 | 300 | 120 | 200 | Simultaneous interpretation equipment is installed permanently. |
| Workshop room 1 | 1 | 108 | 13.0× 8.0 | 2.6 | — | 63 | 100 | — | — | |
| Workshop room 2 | 2 | 60 | 10.0× 6.0 | 2.6 | — | 36 | 80 | — | — | |
| Workshop room 3 | 2 | 60 | 10.0× 6.0 | 2.6 | — | 36 | 80 | — | — | |
| Workshop room 4 | 2 | 60 | 10.0× 6.0 | 2.6 | — | 36 | 80 | — | — | |
| Workshop room 5 | 2 | 60 | 10.0× 6.0 | 2.6 | — | 36 | 80 | — | — | |
| Workshop room 6 | 2 | 60 | 10.0× 6.0 | 2.6 | — | 36 | 80 | — | — | |
| Multipurpose room (A, B) | 4 | 112 | 16.0× 7.0 | 2.6 | — | 60 | 120 | — | — | The space can be partitioned into smaller rooms. |
| Audiovisual room | 4 | 58 | 8.3× 7.0 | 2.6 | — | 36 | 80 | — | — | |
| Kitchen | 4 | 70 | — | 2.4 | 24 | — | — | — | — | |
| Craft room | 4 | 70 | — | 2.4 | 24 | — | — | — | — | |
| Large workshop room | 1 | 238 | 17.0×14.0 | 3.5 | — | 150 | 250 | — | — | |

Width × Depth and the floor area may differ depending on the shape of the room.

Floor plan

1F

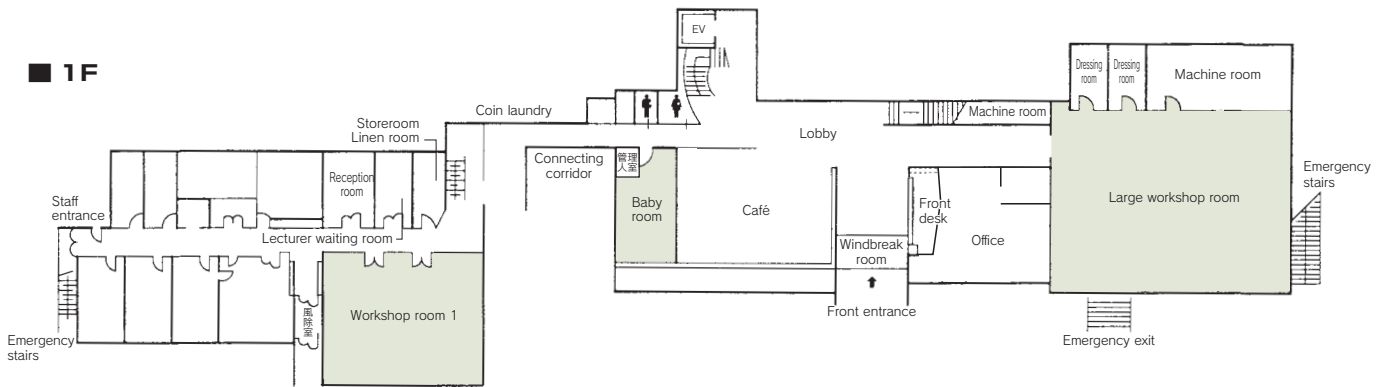

2F

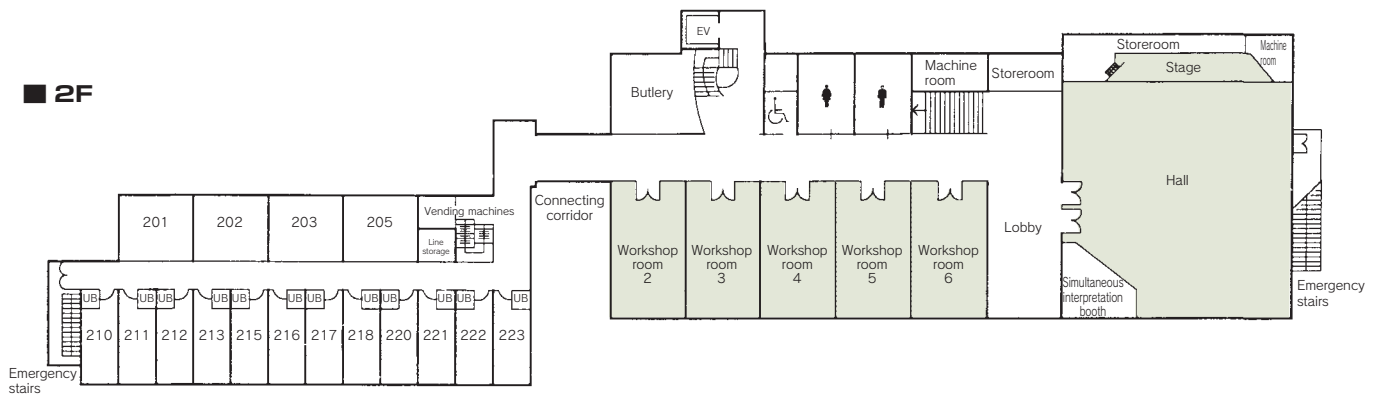

Workshop room 1



Hall