

Uchinada Town Cultural Center

140 Taiseidai, Uchinada-machi, Kahoku 920-0267
 TEL: 076-286-1123 FAX: 076-286-1132



Large hall



■ Number of seats
890 seats (Large hall)



■ Traffic access
 7 min by bus (for Ikadaigaku) from Uchinada Station of Asanogawa Line, Hokuriku Railroad (Get off at Taiseidai and walk for 1 min.)



■ Hours
 9:00am~10:00pm
 Closed: Monday

■ Date to start accepting reservation
 One year before the date of use



■ Accommodation
 None



■ Restaurants/Cafés
 None



■ Parking
85 vehicles (free)



■ Remarks
 None

Floor plan

■ 1F

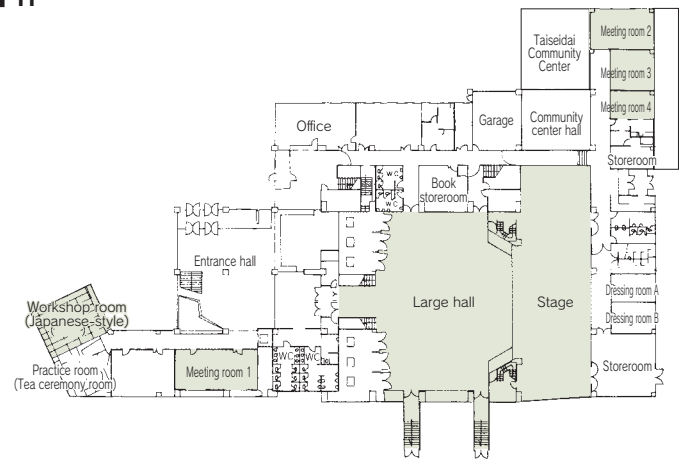

■ Convention site

Site name	Floor	Area(m ²)	Width × Depth (m)	Ceiling height(m)	Capacity (persons)					Remarks
					Fixed seats	School	Theater	Seated	Buffet	
Large hall	-	1,118		8.6	-	-	890	-	-	Fixed seats: 366. Movable seats: 524
Meeting room 1	1	57		3.1	-	30	-	-	-	
Meeting room 2	1	47			-	21	-	-	-	
Meeting room 3	1	33			-	21	-	-	-	
Meeting room 4	1	23			-	12	-	-	-	
Japanese-style workshop room	1	63		2.7	-	55	-	-	-	
Multipurpose room	3	266		2.8	-	-	200	-	-	

Width × Depth and the floor area may not match depending on the shape of the room.