

# Wakura Onsen Omatsuri Hall

2-13-1 Wakura-machi, Nanao 926-0175  
 TEL: 0767-62-4332 FAX: 0767-62-0901



Large meeting room



■ Number of seats  
**150 seats (Large meeting room)**



■ Traffic access  
 5 min by bus from JR Wakura Onsen Station (Get off at Wakura Onsen Omatsuri kaikan-mae)  
 5 min by taxi from JR Wakura Onsen Station  
 20-min walk from JR Wakura Onsen Station  
 5-min drive from Wakura IC of Nanao Tatsuruhama Bypass (Get off Noto Satoyama Highway at Tokuda Otsu JCT, take Tatsuruhama Highway (Nanao City) and the Bypass).



■ Hours  
 9:00am~ 5:00pm  
 Note:  
 The hall may be closed temporarily due to equipment inspection or repair.

■ Date to start accepting reservation  
 Seven days before the date of use



■ Accommodation  
 None



■ Restaurants/Cafés  
 Souvenir area (No restaurant)



■ Parking  
**94 vehicles**  
 (incl. 5 large vehicles)



■ Remarks  
 AED

## Floor plan

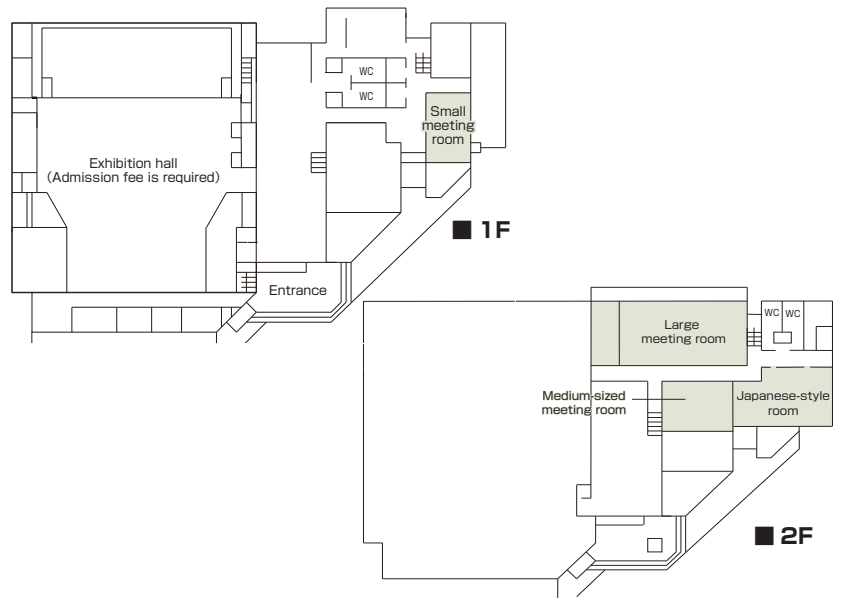

### ■ Convention site

Site name	Floor	Area(m <sup>2</sup> )	Width × Depth (m)	Ceiling height(m)	Capacity (persons)					Remarks
					Fixed seats	School	Theater	Seated	Buffet	
Large meeting room	2	190	22 × 10	3.1	—	100	150	—	—	With a simple stage, screen, partitions for dividing the space into two rooms
Japanese-style room	2	60-tatami-mat	16 × 7.5	2.7	—	40	80	—	—	Floor cushion and low table The space can be partitioned into two rooms.
Medium-sized meeting room	2	82.5	11 × 7.5	2.7	—	20	40	—	—	The space can be partitioned into two rooms.
Small meeting room	1	70	10 × 7	2.7	14	—	—	—	—	Table layout is fixed.

Width × Depth and the floor area may not match depending on the shape of the room.